



BGSS

INDUSTRIAL RADIAL FANS / Backward Curved

Fan Components and Material Properties

Body and fan are made of DKP steel sheet with electrostatic powder coating. All models have asynchronous motor. It is capable of carrying air at a temperature of Max.120°C.

Fan Structure

Single suction, low pressure, radial fan type. The fan blades are aerodynamically curved and provide regular flow. Made of welded fan blades.

Benefits

They can give large amounts of air at low static pressures. Speed can be adjusted with speed control devices.

Speed Control

Optional control devices can be provided. Speed control with frequency inverter can be done in 3-phase products (see BSC-F accessory)

Usage Areas

In the extraction of clean air, industrial areas, domestic and industrial air conditioning system, mine, tunnel ventilation, garbage storage and stables etc. It is used in areas such as the decomposition of odorous gases and toxic gases. It is suitable for smoke extraction and exhaust air exhaust filter.

Technical Drawing and Tables

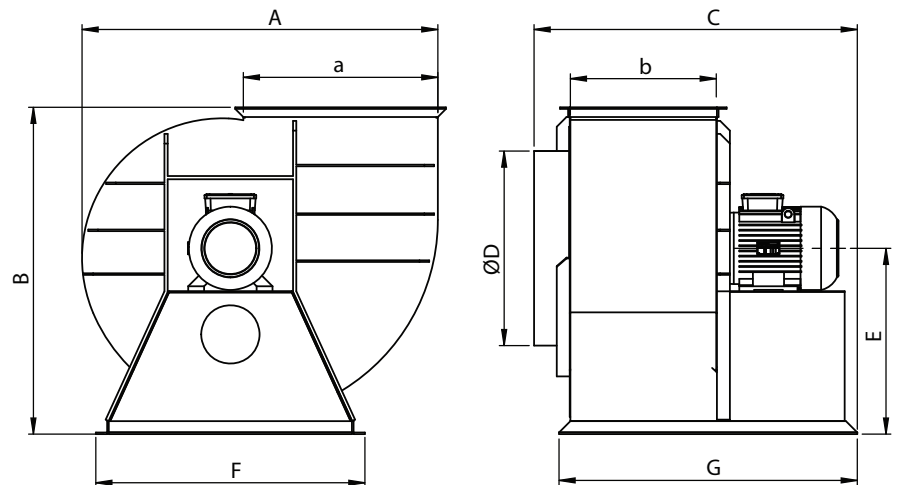

TYPE	A	B	C	D	E	F	G	Outlet frame dimensions	
								a	b
BGSS 1	515	507	474	225	291	420	445	195	185
BGSS 2	580	584	495	260	325	460	460	225	205
BGSS 3	699	680	650	310	386	560	590	335	275
BGSS 4	782	760	685	350	435	635	615	377	300
BGSS 5	872	883	771	400	520	733	696	414	320
BGSS 6	925	900	826	450	515	755	755	436	350
BGSS 7	1040	1015	886	500	602	740	825	522	396
BGSS 8	1100	1008	997	600	573	830	920	588	450
BGSS 9	1130	1080	1047	650	632	990	980	588	500
BGSS 10	1272	1205	1176	700	703	1030	1105	664	550
BGSS 11	1390	1265	1219	750	763	980	1145	786	600
BGSS 12	1450	1365	1275	800	815	1050	1275	788	600
BGSS 13	1576	1465	1275	850	847	1160	1290	826	600

Dimensions are in (mm)

Accessories



TYPE	VOLTAGE	FREQUENCY	POWER	CURRENT	CAPACITOR	SPEED	AIR FLOW	SOUND PRESSURE	INSULATION CLASS	PROTECTION CLASS	WEIGHT
	V	Hz	kW	(A)	(μ F)	r.p.m	m ³ /h	dB(A)	Ins.cl.	IP	kg
BGSS 1M	230	50	0,25	2,1	10	1380	2500	70	F	55	67
BGSS 2M	230	50	0,55	3,3	20	1365	3500	72	F	55	78
BGSS 3M	230	50	0,75	5,4	30	1410	5000	75	F	55	91
BGSS 4M	230	50	1,5	9,8	50	1400	7000	85	F	55	104
BGSS 5M	230	50	2,2	14	60	1425	10000	88	F	55	145
BGSS 6M	230	50	3	20	60	1430	12000	92	F	55	158
BGSS 1T	380	50	0,25	0,87	-	1380	2500	70	F	55	67
BGSS 2T	380	50	0,55	1,6	-	1365	3500	72	F	55	78
BGSS 3T	380	50	0,75	1,92	-	1410	5000	75	F	55	91
BGSS 4T	380	50	1,5	3,5	-	1400	7000	85	F	55	104
BGSS 5T	380	50	2,2	4,9	-	1420	10000	88	F	55	145
BGSS 6T	380	50	3	6,7	-	1430	12000	92	F	55	158
BGSS 7T	380	50	4	8,4	-	1440	15000	95	F	55	175
BGSS 8T	380	50	5,5	11,5	-	1450	18000	98	F	55	225
BGSS 9T	380	50	7,5	16	-	1455	20000	100	F	55	240
BGSS 10T	380	50	11	21,3	-	1465	23000	102	F	55	255
BGSS 11T	380	50	15	29,4	-	1470	25000	103	F	55	325
BGSS 12T	380	50	18,5	34,5	-	1470	30000	105	F	55	375
BGSS 13T	380	50	22	43	-	1475	40000	105	F	55	410

The sound level is measured at a distance of 3 m in open field condition.

Fan Inlet-Outlet Position

